

安全使用

萬能蘇或拖板，慎防過載

Prevent overloading and use
adaptors / extension units safely

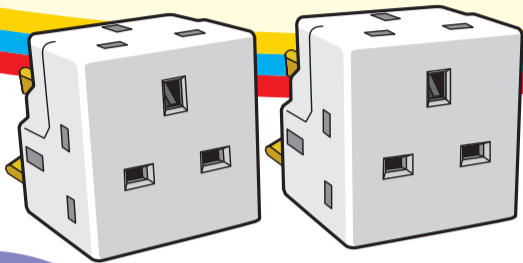
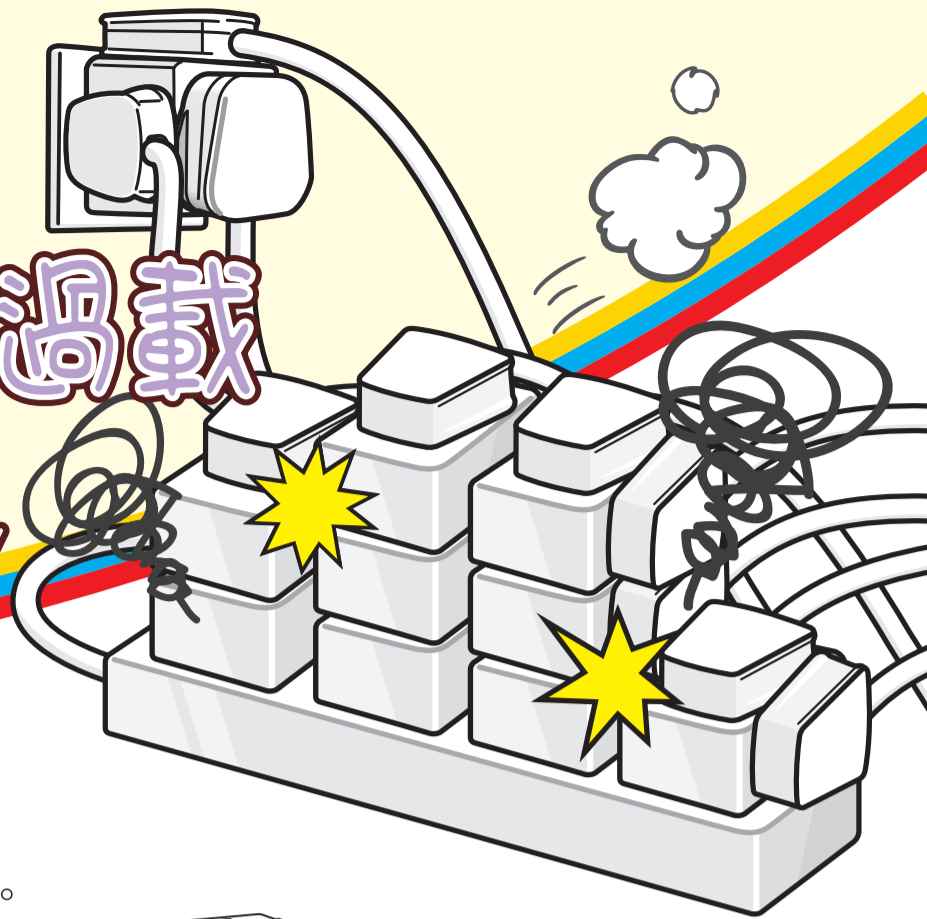

必須選購及使用符合安全規格的萬能蘇和拖板。
Only buy and use adaptors and extension units which
comply with the safety requirements.

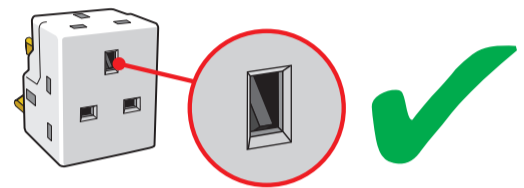
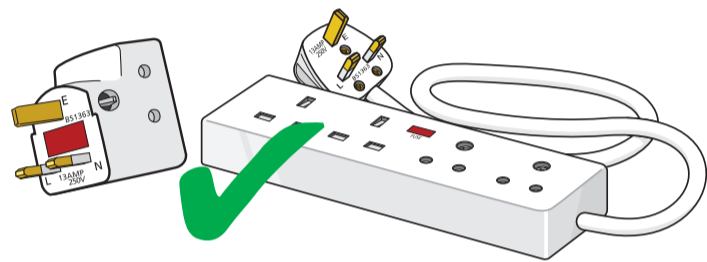

插孔內必須裝有安全活門。
Socket holes must be fitted with
safety shutters.

不要購買或使用有不規則插孔的萬能蘇或拖板，每一面插座只應供一款插頭插入。

Do not buy or use any adaptor or extension unit
which is fitted with irregular socket holes. Each
socket must only allow one type of plug to be
inserted.

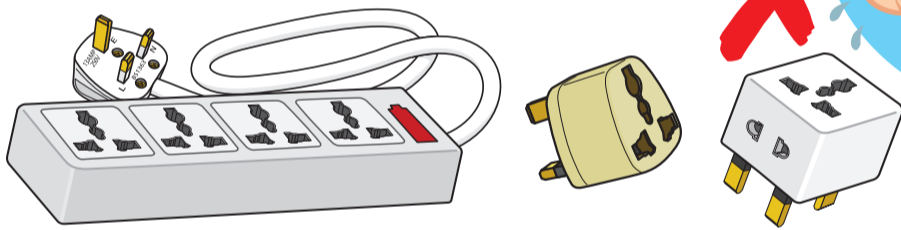

為避免電路負荷過重，造成火警危險，每一個供電插座只可插上一個萬能蘇或一個拖板。拖板上不應插上任何萬能蘇，而萬能蘇上亦不應插上任何拖板。

To prevent circuit overload and fire, no
more than one adaptor or one
extension unit should be
inserted into a socket
outlet. No adaptor
should be inserted
into any extension
unit or vice versa.

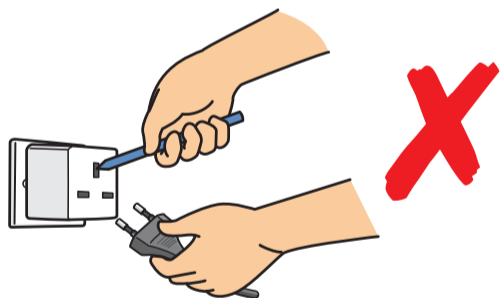
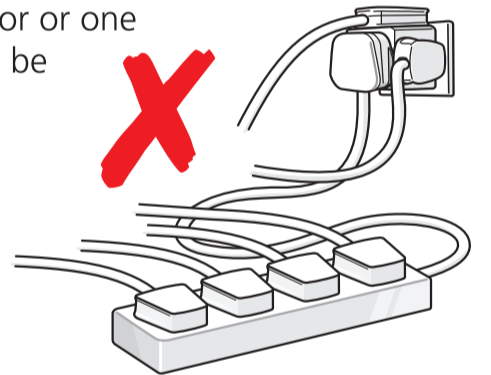

切勿強行將兩腳插頭插入三腳插座、萬能蘇或拖板。
Do not insert a 2-pin plug into a 3-pin-hole socket outlet,
adaptor or extension unit by force.

不要用拖板的軟電線把拖板掛起，以免損壞接線，造成危險。
Do not suspend any extension unit by its pliant power cord.
Otherwise, it may damage the wire connections and cause danger.

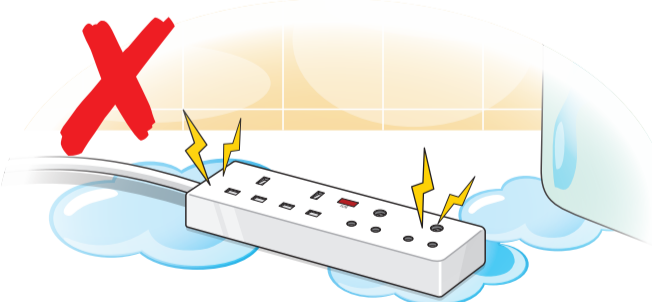
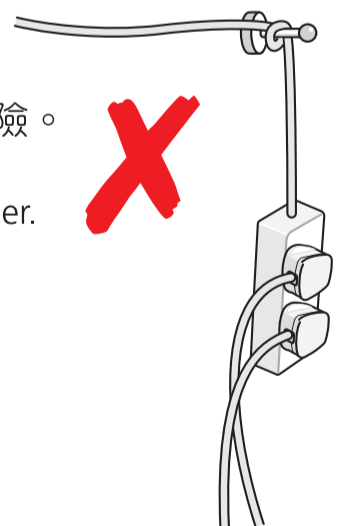

不要將拖板放於潮濕或近水的地方，例如浴室及廚房等。
Do not place any extension unit in a wet or humid environment
(e.g., bathroom and kitchen).

如發現插頭不能穩固地插在萬能蘇或拖板上，或插腳難以插入插孔，便不應使用該萬能蘇或拖板。

Stop using an adaptor or extension unit if
its socket holes cannot firmly hold a plug
or if it is too hard to insert a plug into it.

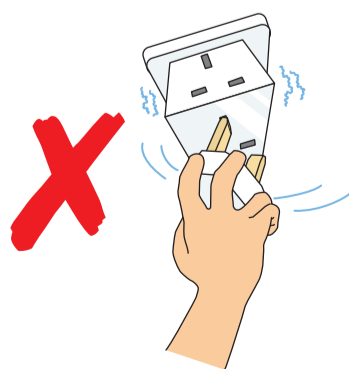

查詢 Enquiries

電話 Tel.: 1823 傳真 Fax: 2895 4929

網址 Homepage: www.emsd.gov.hk

機電工程署  EMSD