



# 定期保養電器

## Regular maintenance of electrical appliances



如電器在使用時出現異常情況，例如發出異常聲音、氣味或有過熱跡象等，應立即停止使用，並安排有經驗的技師檢查及維修。  
Stop using the electrical appliance in case of anomaly, such as abnormal sound, smell or any sign of overheating, etc., and arrange an experienced technician to carry out inspection and repair.

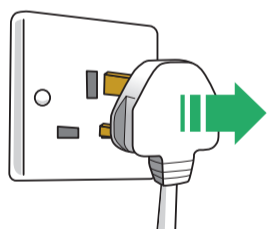

清潔電器前應先拔去插頭。  
Unplug electrical appliances before cleaning.



確保電器的操作環境（例如溫度和濕度）符合說明書的規定。  
Ensure that an electrical appliance operates in an environment (e.g., temperature and humidity) compatible with that specified in the user manual.



遵照說明書的指示清潔電器，並安排定期保養。  
Adhere to the instructions in the user manual in cleaning the electrical appliance and arrange regular maintenance of the electrical appliance.

### 查詢 Enquiries

電話 Tel.: 1823 傳真 Fax: 2895 4929

網址 Homepage: [www.emsd.gov.hk](http://www.emsd.gov.hk)

機電工程署  **EMSD**